

SECTION AT 3-3
SCALE: 1:50

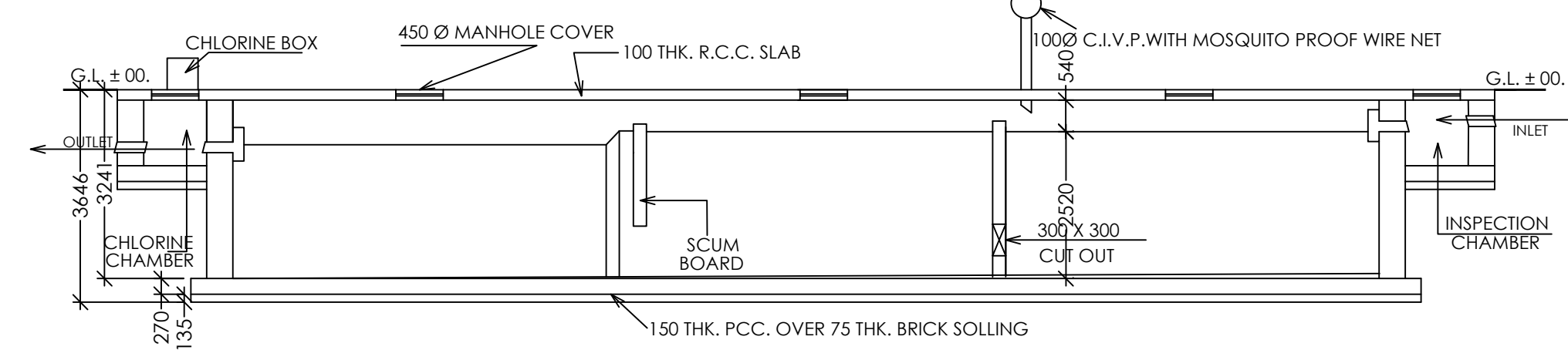

SECTION THROUGH 1-1 SCALE: 1:50

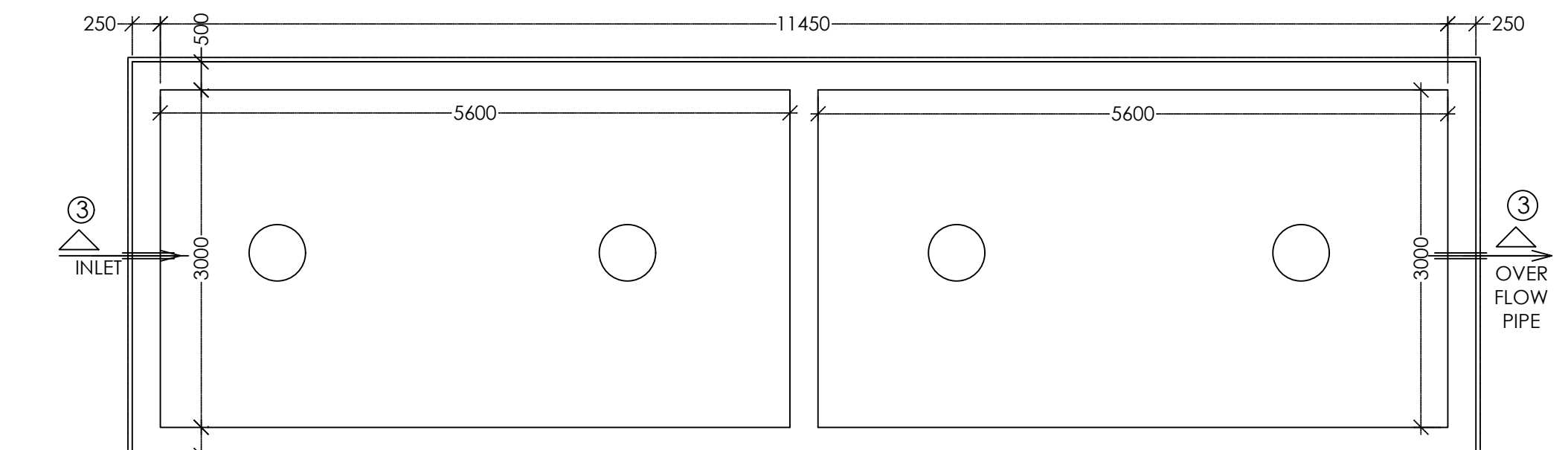

UNDER GROUND WATER RESERVOIR CAPACITY : 50,000 LIT.
DOMESTIC USAGE - CAPACITY 25,000 LIT.
FIRE USAGE - CAPACITY 25,000 LIT.
SCALE: 1:1:50

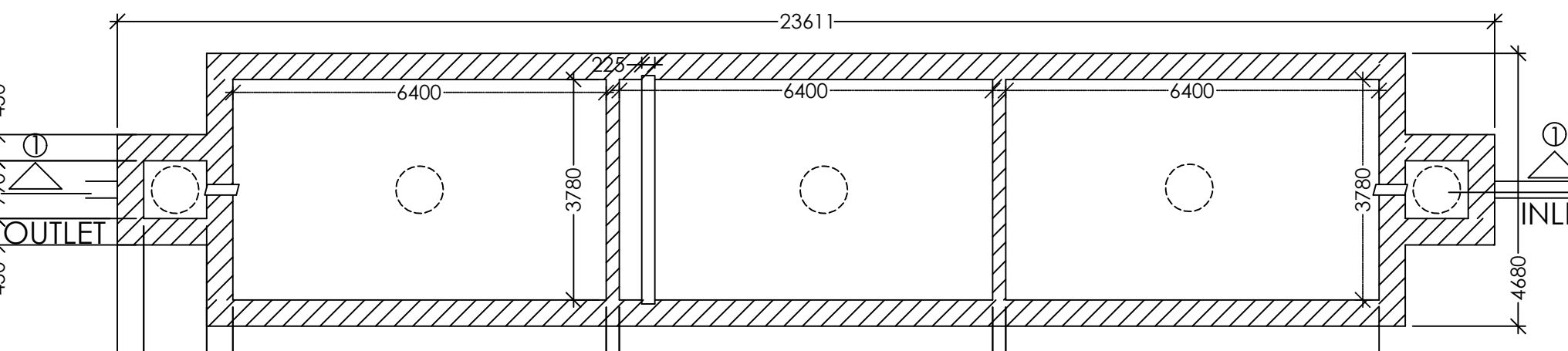

PLAN OF SEPTIC TANK [CAPACITY 200 PERSONS]
SCALE: 1:1:50

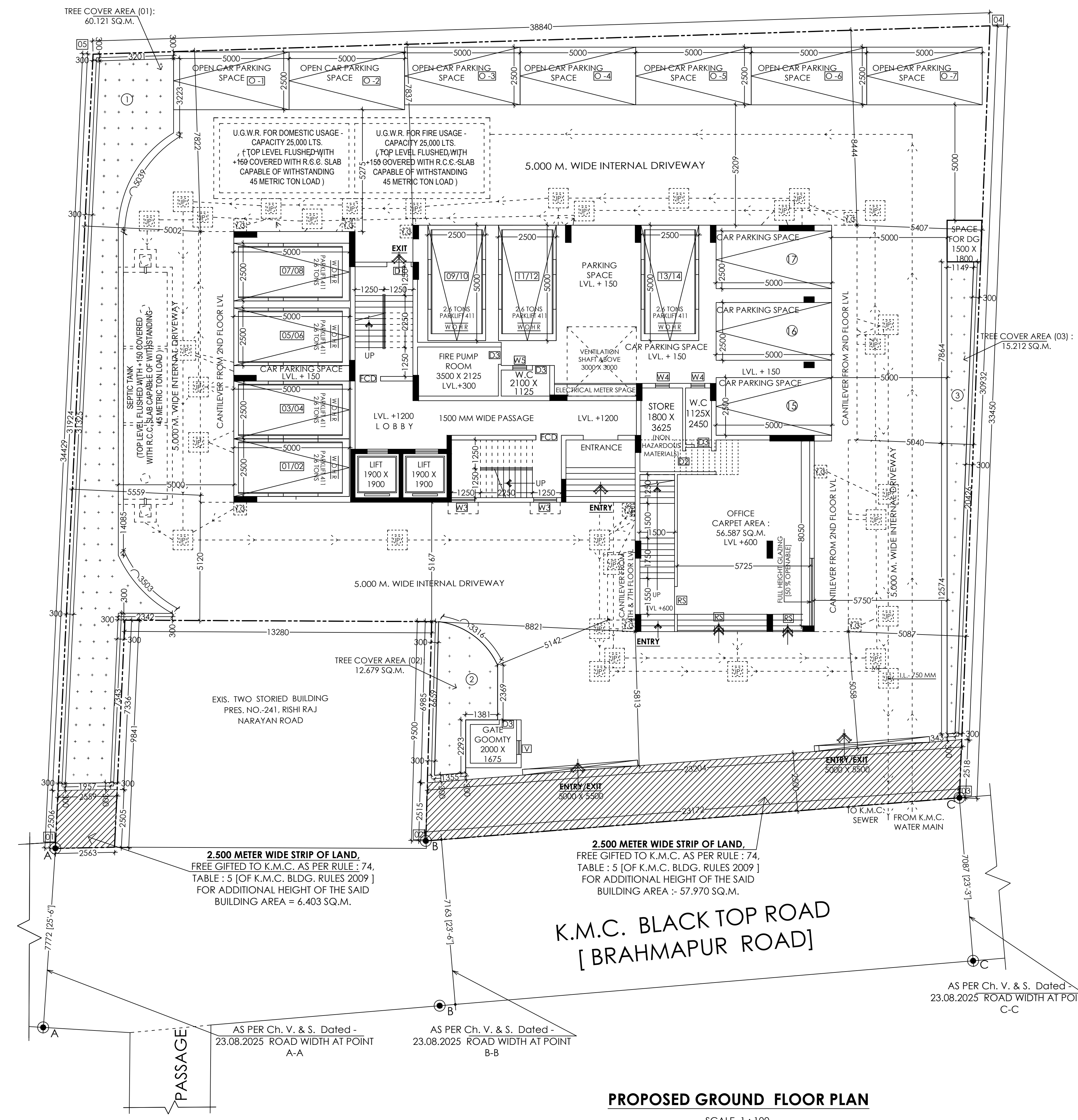

PROPOSED GROUND FLOOR PLAN
SCALE 1:100

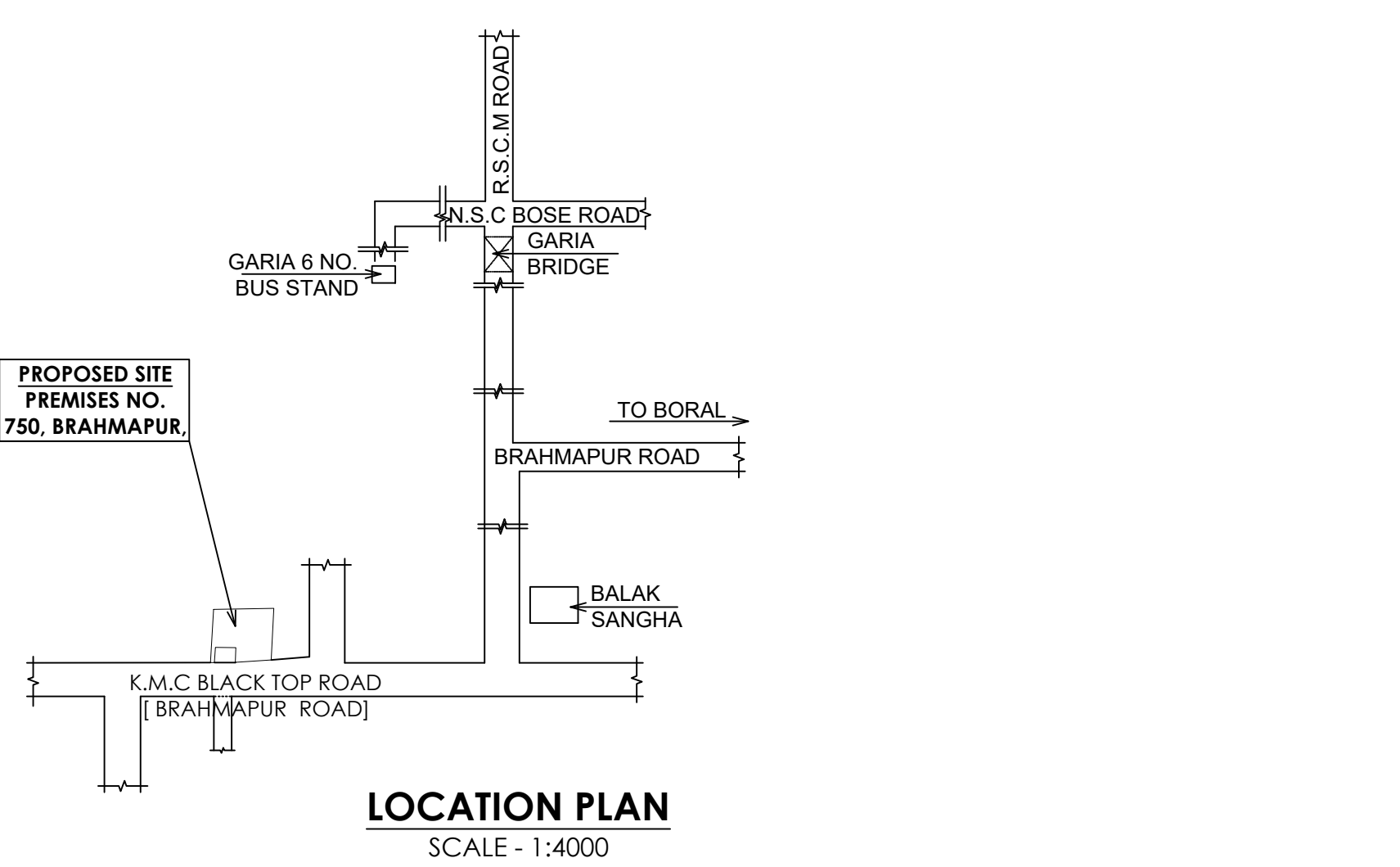

LOCATION PLAN
SCALE: 1:14000

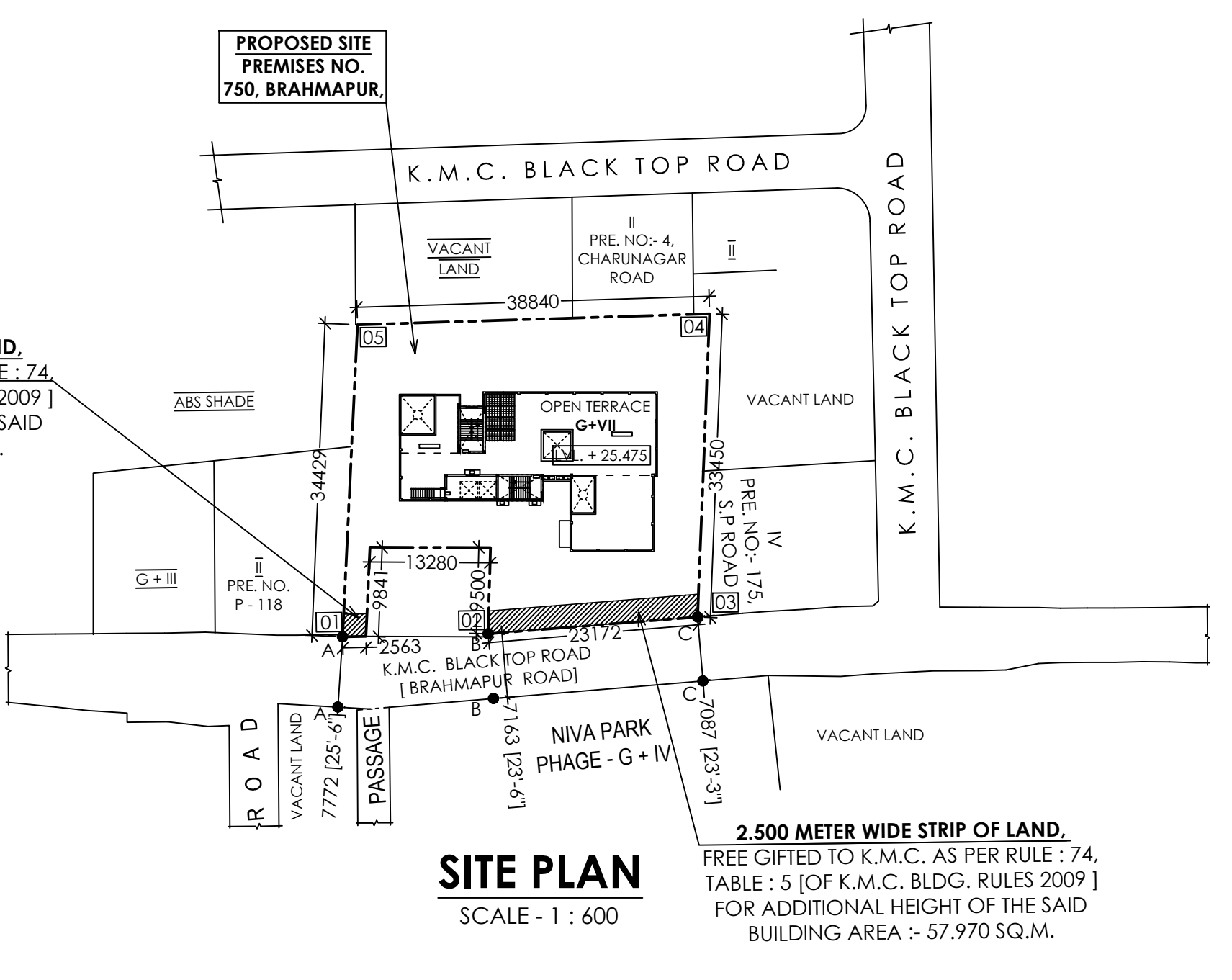

SITE PLAN
SCALE: 1:1:600

| CUPBOARD AREA: | | 1. PROPOSED AREA: | | Verification | | Total Permitted Area | | Net Floor Area | |
|----------------|--------------|-------------------|----------------|--------------|--------------|----------------------|----------------|----------------|----------------|
| FLOOR MTD. | CUPBOARD | Floor Mtd. | Floor area | UP | Down | Gross Area | Star Area | Star Area | UP |
| 1ST. FLOOR | 1,513 SQ.M. | Gr. floor | 346.49 SQ.M. | --- | --- | 346.49 SQ.M. | 346.49 SQ.M. | 346.49 SQ.M. | 346.49 SQ.M. |
| 2ND. FLOOR | 9,075 SQ.M. | 1st floor | 330.96 SQ.M. | 9,000 SQ.M. | 7,200 SQ.M. | 1,488 SQ.M. | 313.199 SQ.M. | 313.199 SQ.M. | 270.323 SQ.M. |
| 3RD. FLOOR | 9,075 SQ.M. | 2nd floor | 379.453 SQ.M. | 9,000 SQ.M. | 7,200 SQ.M. | 1,488 SQ.M. | 361.747 SQ.M. | 361.747 SQ.M. | 331.997 SQ.M. |
| 4TH. FLOOR | 8,300 SQ.M. | 3rd floor | 379.453 SQ.M. | 9,000 SQ.M. | 7,200 SQ.M. | 1,488 SQ.M. | 361.747 SQ.M. | 361.747 SQ.M. | 331.997 SQ.M. |
| 5TH. FLOOR | 9,075 SQ.M. | 4th floor | 379.453 SQ.M. | 9,000 SQ.M. | 7,200 SQ.M. | 1,488 SQ.M. | 361.747 SQ.M. | 361.747 SQ.M. | 331.997 SQ.M. |
| 6TH. FLOOR | 9,075 SQ.M. | 5th floor | 379.453 SQ.M. | 9,000 SQ.M. | 7,200 SQ.M. | 1,488 SQ.M. | 361.747 SQ.M. | 361.747 SQ.M. | 331.997 SQ.M. |
| 7TH. FLOOR | 8,300 SQ.M. | 6th floor | 379.453 SQ.M. | 9,000 SQ.M. | 7,200 SQ.M. | 1,488 SQ.M. | 361.747 SQ.M. | 361.747 SQ.M. | 331.997 SQ.M. |
| | | 7th floor | 379.453 SQ.M. | 9,000 SQ.M. | 7,200 SQ.M. | 1,488 SQ.M. | 361.747 SQ.M. | 361.747 SQ.M. | 331.997 SQ.M. |
| TOTAL | 54,413 SQ.M. | TOTAL | 3794.105 SQ.M. | 43,000 SQ.M. | 30,540 SQ.M. | 10,415 SQ.M. | 3830.145 SQ.M. | 3830.145 SQ.M. | 2579.024 SQ.M. |

| MAIN CHARACTERISTICS OF THE PROPOSAL: | | 2. CAR PARKING CALCULATION: | | | |
|---|------------|---|------------|------------|---------------------------------|
| PART - A | | PART - B | | | |
| 1. ASSESSEE NO.: 31-111-06-0750-0 | | 1. ASSESSEE NO.: 31-111-06-0750-0 | | | |
| 2. NAME OF OWNERS: JAYGRIH NIRMAN (P) LTD., PAHARI MOONRAKER CONSTRUCTION (P) LTD. REPRESENTED BY ITS DIRECTOR OF MR. HARSH VARDHAN KAJARIA | | 2. NAME OF OWNERS: JAYGRIH NIRMAN (P) LTD., PAHARI MOONRAKER CONSTRUCTION (P) LTD. REPRESENTED BY ITS DIRECTOR OF MR. HARSH VARDHAN KAJARIA | | | |
| 3. DETAILS OF REGD. DEED: | | 3. DETAILS OF REGD. DEED: | | | |
| BOOK NO. | VOLUME NO. | PAGES | BENING NO. | DATED | OFFICE |
| 1 | 126 | 192 | 197 | 01/63 | A.D.S.R. ALPORE 24-PARGANAS (S) |
| 4. DETAILS OF REGD. DEED: | | 4. DETAILS OF REGD. DEED: | | | |
| BOOK NO. | VOLUME NO. | PAGES | BENING NO. | DATED | OFFICE |
| 1 | 13 | 363 | 736 | 04/07/1991 | A.D.S.R. ALPORE 24-PARGANAS (S) |
| 5. DETAILS OF REGD. DEED: | | 5. DETAILS OF REGD. DEED: | | | |
| BOOK NO. | VOLUME NO. | PAGES | BENING NO. | DATED | OFFICE |
| 1 | 13 | 364-376 | 737 | 04/07/1991 | A.D.S.R. ALPORE 24-PARGANAS (S) |
| 6. DETAILS OF REGISTERED BOUNDARY DECLARATION: | | 6. DETAILS OF REGISTERED BOUNDARY DECLARATION: | | | |
| BOOK NO. | VOLUME NO. | PAGES | BENING NO. | DATED | OFFICE |
| 1 | 1630-2023 | 7520 TO 7520 TO | 163002423 | 24.08.2023 | D.S.R.-V 24-PARGANAS (S) |
| 7. DETAILS OF REGISTERED STRIP OF LAND(S): | | 7. DETAILS OF REGISTERED STRIP OF LAND(S): | | | |
| BOOK NO. | VOLUME NO. | PAGES | BENING NO. | DATED | OFFICE |
| 1 | 1630-2023 | 75208 TO 75219 | 163002424 | 24.08.2023 | D.S.R.-V 24-PARGANAS (S) |

| 8. ABSTRACT AREA STATEMENT: | |
|---|---|
| AREA OF THE LAND: 178.15 CH. = 14 SQ.FT. (a. 12.929 SQ.FT.) | 120.112 SQ.M. [AS PER BOUNDARY DECLARATION] |
| GREEN AREA PROVIDED: | 40.121 SQ.M. |
| 1. AREA MARKED (I)..... | 12.679 SQ.M. |
| 2. AREA MARKED (II)..... | 12.679 SQ.M. |
| 3. AREA MARKED (III)..... | 14.763 SQ.M. |
| TOTAL..... | 40.121 SQ.M. i.e. 7.328 % OF THE LAND AREA |

| NAME OF THE OWNERS | |
|--|--|
| JAYGRIH NIRMAN (P) LTD. | |
| PAHARI MOONRAKER CONSTRUCTION (P) LTD. | |
| REPRESENTED BY ITS DIRECTOR OF MR. HARSH VARDHAN KAJARIA | |
| CERTIFICATE OF ARCHITECT: | |
| I, THE ARCHITECT, HAVE PREPARED THE ARCHITECTURAL DRAWINGS FOR THE PROPOSED CONSTRUCTION AND THE FOUNDATION SYSTEM PROPOSED THEREIN IS SAFE AND STABLE IN ALL RESPECTS FROM GEO-TECHNICAL POINT OF VIEW. | |
| NAME OF ARCHITECT: Mr. ANUPAM GHOSH, Registered Architect, Reg. No. C.A./2005/36555. | |
| CERTIFICATE OF STRUCTURAL ENGINEER: | |
| I, THE STRUCTURAL ENGINEER, HAVE PREPARED THE STRUCTURAL DESIGN AND DRAWING OF BOTH FOUNDATION AND SUPER STRUCTURE OF THE BUILDING AND THE FOUNDATION SYSTEM PROPOSED THEREIN IS SAFE AND STABLE IN ALL RESPECTS FROM GEO-TECHNICAL POINT OF VIEW. | |
| NAME OF STRUCTURAL ENGINEER: Mr. BIBEK BIKASH MULLICK, Structural Engineer (ESE/1175). | |
| CERTIFICATE OF GEO-TECHNICAL ENGINEER: | |
| I, THE GEO-TECHNICAL ENGINEER, HAVE CONDUCTED THE SOIL INVESTIGATION WORKING THEREIN IS SAFE AND STABLE IN ALL RESPECTS FROM GEO-TECHNICAL POINT OF VIEW. | |
| NAME OF GEO-TECHNICAL ENGINEER: BHASKARJIYOTI ROY (C.T.1/50). | |

| SPECIFICATION OF CONSTRUCTION: | |
|--|--|
| 1. 200 THE. AAC BRICK WORK FOR EXTERNAL WALL IN SUPER STRUCTURE IN 1:4 | |
| 2. 125 & 100 THE. AAC BRICK WORK FOR INTERNAL WALL IN 1:4 | |
| 3. LEAN CONCRETE, 1:3:4 WITH 19MM DOWN GRADE STONE CHIPS (M-15) | |
| 4. R.C.C. 1:2:4 FOR ROOF SLAB, BEAM, INTEL, CHAJJA ETC. | |
| 5. CEILING & CHAJJA IN 1:4 | |
| 6. CEILING & CHAJJA IN 1:4 | |
| 7. 7.5 MM. TH. SINGLE BRICK FLAT SOLING ON FOUNDATION & 400 LVL. TO THE FINISHED GROUND FLOOR LVL. | |
| 8. 9. READ WIDTH 250 EACH & RISE HEIGHT IS 151.250 EACH | |
| 10. FLOOR TO SLAB HEIGHT SHALL BE 200 MM. & THICKNESS OF THE SLAB SHALL BE 100 MM. | |
| 11. THEREFORE, CLEAR HEIGHT OF EACH FLOOR SHALL BE 2925 MM. | |
| 12. STORE (Non Hazardous Material) | |
| 13. STEEL MUST CONFORMED WITH IS 1786 | |
| GRADE OF CONCRETE - M 25 (C : S : ST : 1 : 1 : 2) & GRADE OF STEEL - Fe500 | |
| CEMENT - ORDINARY PORTLAND & SAND - MEDIUM COURSE | |
| STONE CHIPS - 20 MM. DOWN GRADE | |
| OTHER DETAILS AS PER ARCHITECT OR ENGINEER - IN - CHARGE | |

| DOOR & WINDOW SCHEDULE: | | | | | |
|-------------------------|-------------|------|-------------|-------------|-------------|
| MARKED | TYPE | SIZE | UNIT | HEIGHT | DEPTH |
| F01 | SOLID FLUSH | 2100 | 1100 X 2100 | 2100 | 1100 X 2100 |
| D1 | SOLID FLUSH | 2100 | 1050 X 2100 | 2100 | 1050 X 2100 |
| D2 | SOLID FLUSH | 2100 | 900 X 2100 | 2100 | 900 X 2100 |
| D3 | SOLID FLUSH | 2100 | 750 X 2100 | 2100 | 750 X 2100 |
| SD | GLAZED | 2100 | AS PER DWG. | 2100 | AS PER DWG. |
| W1 | GLAZED | 750 | 2100 | AS PER DWG. | 1500 X 1350 |
| W2 | GLAZED | 750 | 2100 | 1200 X 1350 | 1000 X 1350 |
| W3 | GLAZED | 1100 | 2100 | 900 X 1000 | 900 X 1000 |
| W4 | GLAZED | 1350 | 2100 | 600 X 750 | 600 X 750 |

| CO-ORDINATE IN WGS 84 AND SITE ELEVATION (AMSL): | | |
|---|---------------------------|-----------------------|
| REFERENCE POINTS MARKED IN THE PLAN OF THE PROPOSAL | CO-ORDINATE IN WGS 84 | SITE ELEVATION (AMSL) |
| 1 | 22°27'22.97N 88°21'51.27E | 5.31 METER |
| 2 | 22°27'23.11N 88°21'51.27E | 5.31 METER |
| 3 | 22°27'23.07N 88°21'51.57E | 5.31 METER |
| 4 | 22°27'23.61N 88°21'51.57E | 5.31 METER |
| 5 | 22°27'23.29N 88°21'52.17E | 5.31 METER |
| 6 | 22°27'23.53N 88°21'52.41E | 5.31 METER |

| NAME OF THE OWNERS | |
|---|--|
| JAYGRIH NIRMAN (P) LTD. | |
| PAHARI MOONRAKER CONSTRUCTION (P) LTD. | |
| REPRESENTED BY ITS DIRECTOR OF MR. HARSH VARDHAN KAJARIA | |
| NAME OF ARCHITECT | |
| Mr. ANUPAM GHOSH, Registered Architect, Reg. No. C.A./2005/36555. | |
| NAME OF STRUCTURAL ENGINEER | |
| Mr. BIBEK BIKASH MULLICK, Structural Engineer (ESE/1175). | |
| NAME OF GEO-TECHNICAL ENGINEER | |
| BHASKARJIYOTI ROY (C.T.1/50). | |

TITLE: ON SITE GROUND FLOOR PLAN, LOCATION PLAN, SITE PLAN, SEPTIC TANK DETAILS & U.G.W.R. DETAILS.
 DRAWING SHEET NO. 01
 DEALT: D. SAHA
 DATE: 03.06.2025
 ALL DIMENSIONS ARE IN M.M. (UNLESS OTHERWISE MENTIONED)
 ARCHITECTURAL CONSULTANTS: COLLAGE ARCHITECTS
 1486, RAJDAKSHIN ROAD, (OPPOSITE PURBA ABASAN, DE BLOCC), KOLKATA 700 107, INDIA
 PHONE NO. 9331402209, EMAIL: collage.architects@gmail.com
 THIS DRAWING IS A PROPERTY OF COLLAGE. ANY MODIFICATION, CHANGES, DEVIATIONS IS NOT PERMISSIBLE WITHOUT PRIOR INTIMATION OF THE ARCHITECT. TO THE CONTRARY THIS WILL BE TREATED AS ILLEGAL ACT.
 BUILDING PERMIT NO.: 2025110272
 SANCTION DATE - 20.12.2025
 VALID UPTO - 19.12.2030
 DIGITAL SIGNATURE OF ASSISTANT ENGINEER(C)/BLDG./BR/01
 DIGITAL SIGNATURE OF EXECUTIVE ENGINEER(C)/BLDG./BR/01